

SCANMASKIN

MACHINES—MINERALS—KNOW-HOW

SCANMASKIN 650



The Scanmaskin 650 is a robust and stable grinder, fully constructed from steel. This floor grinder is designed for both residential and commercial projects, featuring a grinding width of 650 mm.

The Scanmaskin 650 is extremely durable and easy to maintain. It is also designed to reduce vibration and strain-related injuries for the operator. Additionally, the Scanmaskin 650 offers the option for wet grinding by simply connecting a water hose.

The machine is equipped with our patented drive system to power its three grinding heads. This drive system is built with high-quality components, including a double-sided timing belt combined with a gear ring. These carefully selected components ensure high operational reliability and superior quality.

ROBUS & STABLE GRINDER MADE OF STEEL



GRINDING DISC
PLANETARY



GRINDING WIDTH
650 mm / 25,6"



WEIGHT
320 kg / 705 lbs

TECHNICAL DATA

SCANMASKIN 650

	Standard	1-fas
Voltage:	400 V 3~	230 V 1~
Motor power:	7,5 kW / 10 hp	4 kW / 5 hp
Current:	16 Amp.	30 Amp.
Frequency:	50-60 Hz	50-60 Hz
Grinding speed:	350-1100 rpm	350-900 rpm
Grinding disc:	3 x 220 mm / 3 x 8,5"	3 x 220 mm / 3 x 8,5"
Grinding width:	650 mm / 25,6"	650 mm / 25,6"
Weight:	320 kg / 705 lbs	320 kg / 705 lbs
Grinding pressure:	180 kg / 396 lbs	180 kg / 396 lbs
Other:	CE-marking	CE-marking

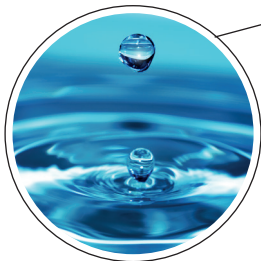

Option for wet grinding by simply connecting a water hose



Fully constructed from steel

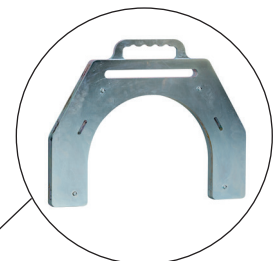

Weight package available 18 kg / 39 lbs.

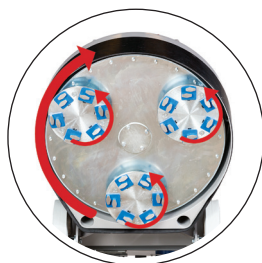

Equipped with our patented planetary system with three head drums.



SCANMASKIN
MACHINES-MINERALS-KNOW-HOW

www.scanmaskin.com